

Detail is applicable for APP, SBS and Self-Adhered POLYGLASS Membranes.

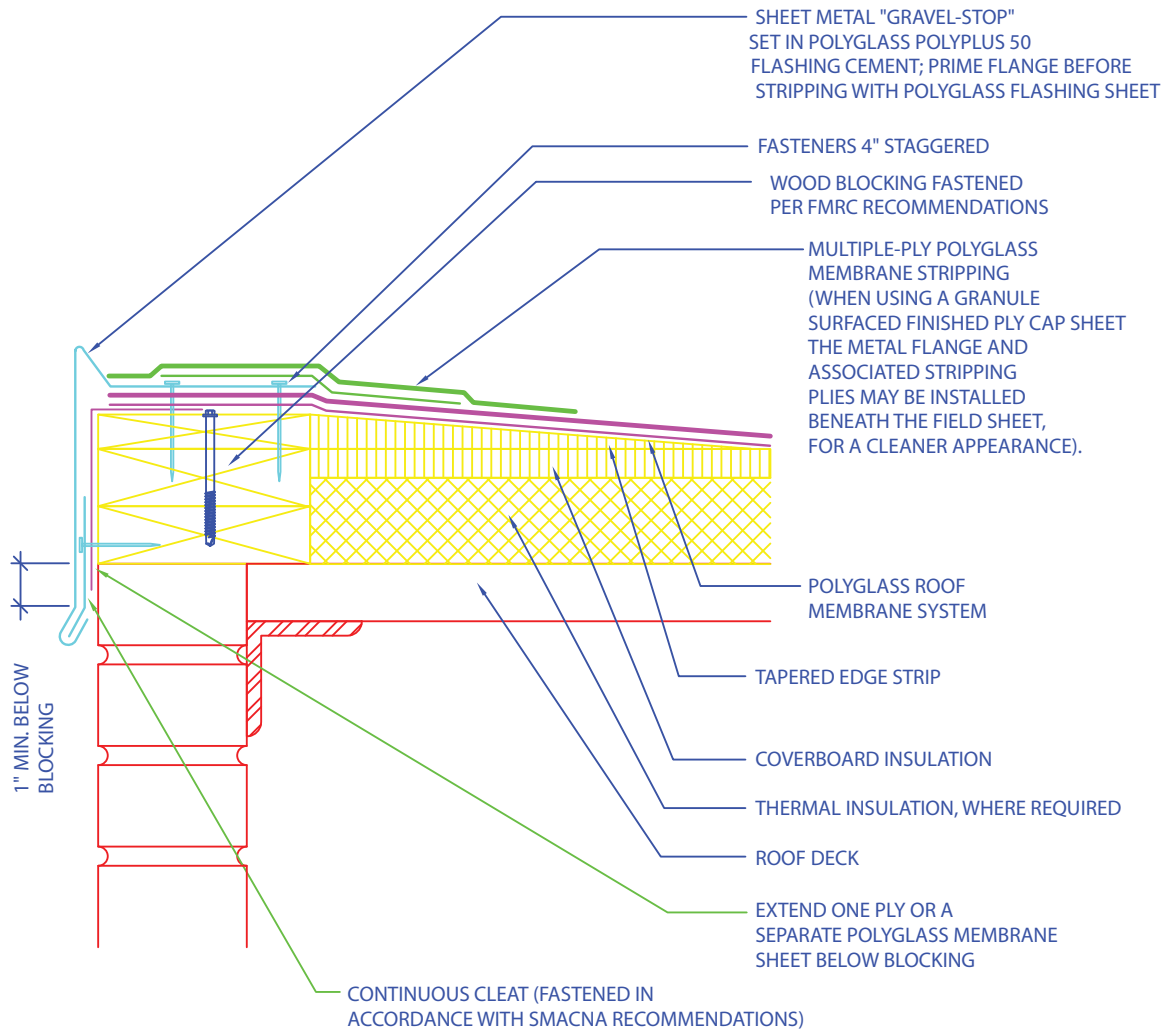

NOTES:

1. ATTACH WOOD NAILER TO WALL/DECK IN ACCORDANCE WITH FMRC GUIDELINES, AS PER SECTION 1-28, REGARDING WINDLOADS TO ROOF SYSTEMS & DECK SECUREMENT.
2. WOOD BLOCKING MAY BE SLOTTED FOR VENTING OF WET-FILL DECKS OR OTHER APPLICABLE CONSTRUCTIONS
3. THIS DETAIL SHOULD BE USED ONLY WHERE THE DECK IS SUPPORTED BY THE OUTSIDE WALL
4. REFER TO SMACNA RECOMMENDATIONS & DETAILS REGARDING METAL THICKNESS & CLEAT REQUIREMENTS
5. MEMBRANE ENDLAPS MUST BE 6" MINIMUM & FULLY ADHERED AT ALL MEMBRANE IN LOCATIONS WHERE "FAST LAP" IS NOT PRESENT

EMBEDDED EDGE METAL FLASHING (GRAVEL STOP)

NUMBER: PG002

DATE: 05.17.01

REVISION: 02/12/2008



Polyglass USA Inc.
 Corporate Office and Manufacturing Facility: 150 Lyon Drive, Fernley, Nevada 89408
 Phone (775) 575-6007 - Fax (775) 575-2314 - Toll Free (800) 222-9782
 Manufacturing Facilities: 555 Oakridge Road, Humboldt Industrial Park, Hazleton, Pennsylvania 18201
 Tel. (570) 384-1230 - Fax (570) 384-3282 - Toll Free (800) 894-4563
 621 Snively Avenue, Winterhaven, Florida 33880
 Phone: 863-297-5000 - Fax: 863-297-5858 - Toll Free: 866-802-8017
 e-mail: technical@polyglass.com • www.polyglass.com